



# White

## User Guide

C88-W2-B / C88-W2-P



|                                      |   |
|--------------------------------------|---|
| Contents                             | 1 |
| Machine Overview                     | 2 |
| General Safety Information           | 3 |
| Getting Started                      | 4 |
| Looking After Your Machine – Filters | 5 |
| Looking After Your Machine – Filters | 6 |
| FAQs                                 | 7 |
| Other Information                    | 8 |
| Guarantee                            | 9 |

- 1 Dirt container handle
- 2 Dirt container lid
- 3 Power on/off button
- 4 Main body
- 5 Dirt container
- 6 Hose connector
- 7 Base
- 8 Cord rewind button (hidden)
- 9 Dirt container release button
- 10 Variable power dial
- 11 Wheel outer
- 12 Wheel inner
- 13 Inner separator
- 14 Outer cyclone
- 15 Dirt container release latch
- 16 Upholstery tool
- 17 Crevice tool
- 18 Dusting brush
- 19 TurboTool  
(some models only)

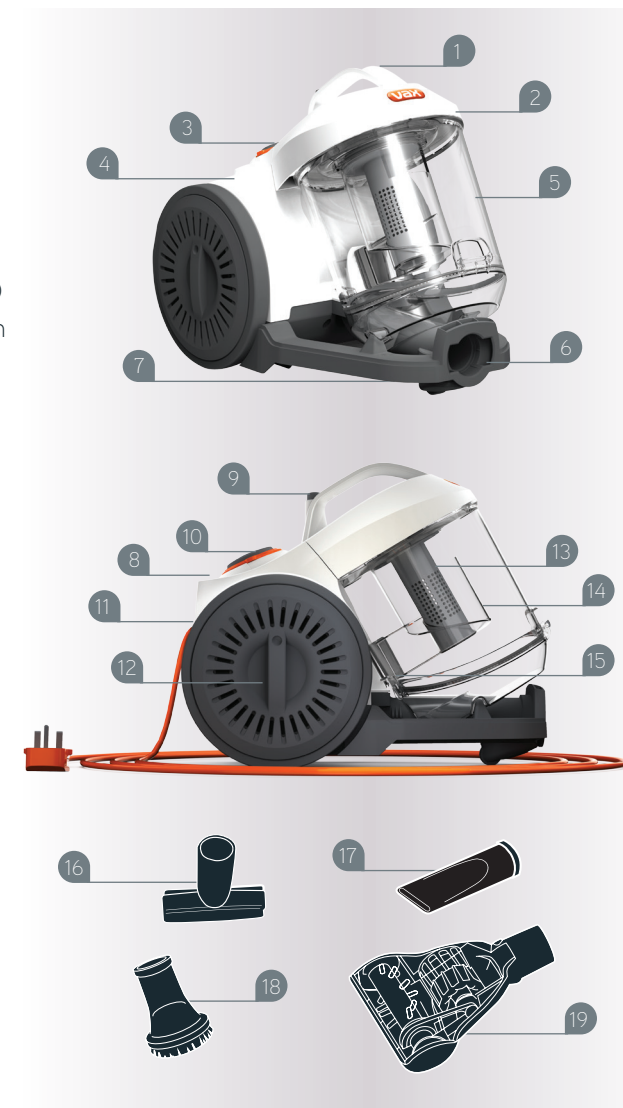

**NOTE:** Some parts may vary according to model. Please check inside flap of box for more details.

**This vacuum cleaner is intended for household use only and NOT for commercial or industrial use.**

Please keep instructions for further use. When using the vacuum cleaner, basic safety precautions should always be observed, including the following:

1. Do not leave the vacuum cleaner unattended when plugged in. Unplug the appliance from the socket when not in use.
2. Only use the vacuum cleaner indoors on dry surfaces.
3. Turn off the on/off switch on the vacuum cleaner controls before disconnecting or connecting from the mains supply.
4. Always unplug the vacuum cleaner before connecting or disconnecting the vacuum hose and accessories.
5. Children should be supervised to ensure that they do not play with the appliance.
6. This appliance is not intended for use by children under eight years of age and persons with reduced physical, sensory or mental capabilities or lack of experience and knowledge, unless they have been given supervision or instruction concerning use of the appliance in a safe way and understands the hazards involved.
7. Cleaning and maintenance shall not be made by children without supervision.
8. The appliance should only be used as described in the quick start guide or in the full online user guide.
9. Only Vax recommended attachments should be used with this appliance.
10. Do not use this vacuum cleaner if it has been dropped, damaged, left outdoors or dropped into water. Do not use this vacuum cleaner with a damaged cord or plug. If the supply cord is damaged return the vacuum cleaner to a Vax authorised Service Agent or a suitably qualified person for examination, repair or adjustment.
11. Do not pull or carry this appliance by the cord. Do not use the cord as a handle, close a door on the cord or pull the cord around sharp edges or corners. Do not run the vacuum cleaner over the cord. Keep the cord away from heated surfaces.
12. Do not handle the plug or the vacuum cleaner with wet hands.
13. Keep hair, loose clothing, fingers and all parts of the body away from openings and moving parts.
14. Do not pick up any hot coals, cigarette butts, matches or any hot, smoking or burning objects.
15. Do not pick up any flammable or combustible materials (lighter fluid, petrol, kerosene etc.) or use in the presence of explosive liquids or vapours.
16. Do not vacuum up harmful or toxic material (chlorine, bleach, ammonia, drain cleaner etc.)
17. Do not vacuum up hard or sharp objects such as glass, nails, screws, coins etc.
18. Store the vacuum cleaner in a cool, dry area.
19. Use only CE approved 13 amp extension cords. Non-approved cords may overheat. Care should be taken to arrange the cord so that the cord cannot be tripped over.
20. Do not put any objects into openings. Do not use with any openings blocked and do not restrict airflow. Keep all openings free of dust, lint, hair or anything that might reduce airflow.
21. Do not use without all of the filters in place.
22. Take extra care when vacuuming on the stairs.
23. Please ensure that the brushbar is turned off when you are vacuuming on the stairs.
24. Keep vacuuming area well lit.

PLEASE READ SAFETY INFORMATION BEFORE USE (p3)

Before plugging the cord into the electrical socket, make sure the switch is in the 'off' position.

## Assembling your cylinder

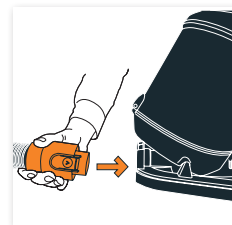

Insert the end of the hose into the unit. Ensure the hose has clicked into place.

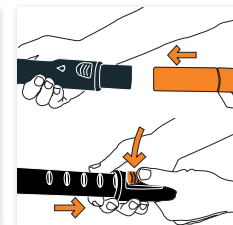

Slot the metal telescopic extension tube and hose handle together. All accessories can be fitted to the end of the metal telescopic extension tube and hose handle.

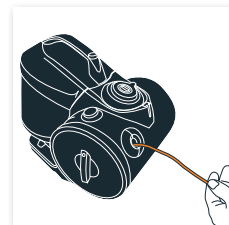

Fully unwind the power cord. A yellow mark on the cord indicates the recommended cord length. Do not exceed the cord beyond the yellow mark.

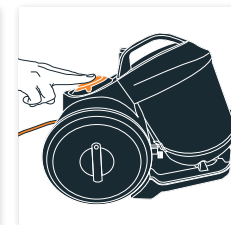

Plug in and switch the unit on by pressing the power button.

## How to use

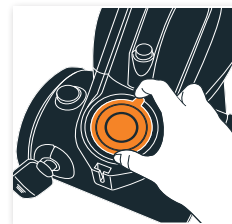

Adjust the power by rotating the dial for different surfaces as required.

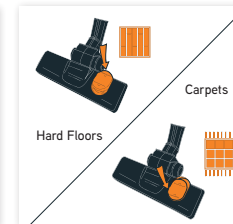

For use on carpets click rocker switch forward. For use on hard floors click rocker switch back.

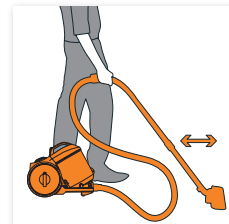

## Packing away and storage

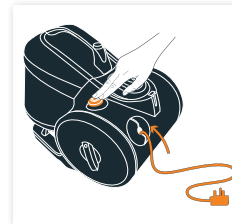

Cable rewind button is located at the rear of the machine. After unplugging press the cable rewind until the cord is fully retracted.

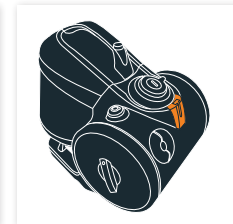

For convenience there is a parking slot located at the rear of the vacuum cleaner where the floor head and tubes can be attached for storage and carrying.

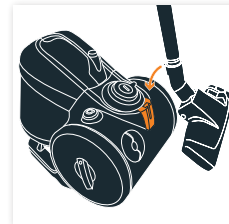

# Looking After Your Machine – Filters

**IMPORTANT:** If the air inlet, hose or telescopic tube is blocked, switch off the vacuum cleaner and remove the blockage(s) before re-starting the vacuum cleaner.

**IMPORTANT:** The motor is equipped with a thermal cut-out. If for any reason the unit should overheat, the thermostat will automatically turn the unit off. Should this occur, unplug the vacuum cleaner from the electrical socket and turn off the switch. Remove and empty the dirt container. Check the hose for blockages. Clean the filters. Allow the unit to cool for approximately one hour (if you have cleaned the filters you will need to wait twenty four hours for the filters to dry before putting them back in the machine). To re-start the machine, plug it into an electrical socket and switch it back on.

## Emptying and cleaning the dirt container

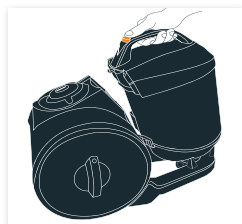

Remove dirt container by pushing down the dirt container release button and lifting the dirt container.

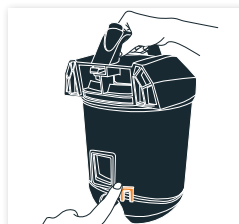

Hold the dirt container over a bin and press the dirt release latch (located at the rear of the dirt container).

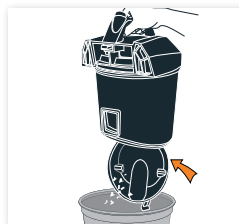

Lift out the pre-motor filter.

## Cleaning the pre-motor filter

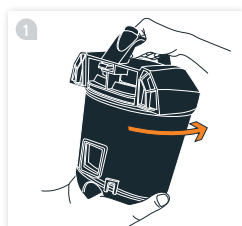

Hold the dirt container and twist the lid anti-clockwise.



Lift the lid to reveal the pre-motor filter.



Tap excess dirt from the filter. Rinse under a tap and leave to dry for 24 hours.



40°C  
MAX

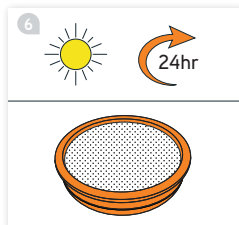

24hr

# Looking After Your Machine – Filters

## Cleaning the shroud



Hold the dirt container and twist the lid anti-clockwise.



Lift the lid to reveal the pre-motor filter.

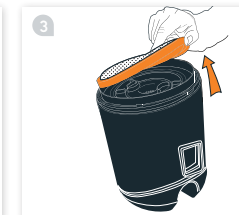

Lift out the pre-motor filter.

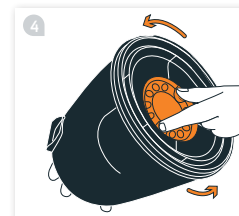

Hold the container and twist the inner separator anti-clockwise.

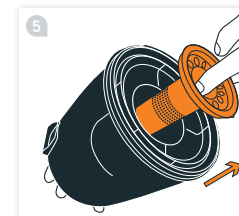

Remove the inner separator from the container.

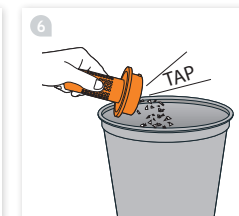

Dislodge any excess dirt by gently tapping the inner separator over a container.

## Cleaning the HEPA post-motor filter

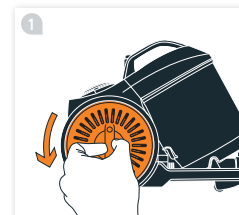

Post motor filter is located in the left side wheel. Hold the centre of the wheel and twist wheel cover anti-clockwise.

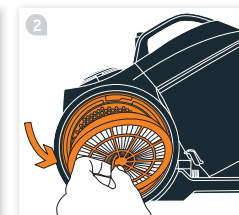

With the wheel cover off the post-motor filter is easily removed.



Tap all excess dirt off the filter. Do not wash.

## Removing blockages from the TurboTool



Unlock

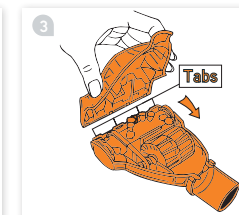
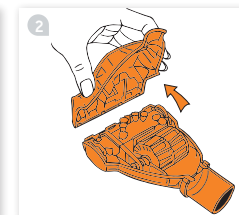

Tabs

**Warning:** To reduce the risk of personal injury, unplug the vacuum cleaner before performing maintenance/troubleshooting checks.

## Is there an accessory missing?

- Check the 'Getting Started' page in this guide or the box that the machine came in to make sure that the part is definitely included in your unit.
- If it is missing, we're here to help. Simply call us on **0844 412 8455**

## Why won't the vacuum cleaner pick up?

- The filters may need cleaning, please refer to the 'Looking After Your Machine – Filters' page of this user guide (p5-6)
- The separator may be clogged, please refer to the 'Looking After Your Machine – Filters' page of this user guide (p5-6)
- There may be a blockage in the hose, please check the hose and remove the blockage
- The dirt container may be full or blocked, please refer to the 'Looking After Your Machine – Emptying and cleaning dirt container' page of this user guide (p5)
- The dirt container may be incorrectly installed, please ensure the dirt container is locked in place

## Why won't the accessories pick up properly?

- The TurboTool may be blocked, please refer to the 'Looking After Your Machine – Removing Blockages' page in this user guide (p6)
- The accessory may be broken

## What do I do if an accessory/the unit becomes damaged or broken?

- Please check if the damage is with the accessory or the unit. To do this, firstly remove the accessory from the unit and check if there is suction from the hose. If there is suction from the hose this confirms that the damage is with the accessory. Please visit 'spares shop website' – [vax.co.uk/support](http://vax.co.uk/support)
- If having done the above checks, checked the hose for blockages and cleaned the filters there is still no suction/limited suction from the hose, please call our Vax Careline 0844 412 8455

## Why is dust escaping from the vacuum?

- The filters may not be installed correctly, please refer to the 'Looking After Your Machine – Filters' page of the user guide (p5-6)
- The dirt container may be full or blocked, please refer to the 'Looking After Your Machine – Emptying and cleaning dirt container' page of this user guide (p5)
- The filters may need cleaning, please refer to the 'Looking After Your Machine – Filters' page of this user guide (p5-6)
- There may be a blockage in the hose, please check the hose and remove the blockage

## Why does my vacuum cleaner have no power?

- It may not be plugged into the electrical socket correctly. Ensure that the plug is pushed into the electrical socket securely
- The electrical socket may not be working. Check the fuse or breaker and consult an electrician
- The motor thermostat may have tripped. Switch off and unplug the vacuum cleaner. Check the unit for blockages, clean the filters – please refer to the 'Looking After Your Machine – Filters' page of this user guide (p6) and clean the separator – please refer to the 'Looking After Your Machine – Emptying and cleaning dirt container' page of this user guide (p5). Leave the vacuum cleaner for 24 hours before switching the vacuum cleaner back on

## Why does the vacuum cleaner cut out?

- The motor is equipped with a thermal cut-out. If for any reason the unit should overheat, the thermostat will automatically turn the unit off. Should this occur, unplug the vacuum cleaner from the electrical socket and turn off the switch. Remove and empty the dirt container. Check the hose for blockages. Clean the filters. Allow the unit to cool for approximately 1 hour (if you have cleaned the filters you will need to wait 24 hours for the filters to dry before putting them back in the machine)

## What do I do if the unit becomes damaged or broken?

- We're here to help. Simply call **0844 412 8455** or visit [vax.co.uk](http://vax.co.uk)

## UK Service & Help

Any queries or concerns about using your Vax, simply visit: [vax.co.uk/support](http://vax.co.uk/support) – [vaxireland.ie](http://vaxireland.ie) or call the Vax Careline. Calls are charged at the UK local rate. Please make a note of the serial number and model number of the vacuum cleaner before calling.

Vax Careline:

(UK) 0844 412 8455

(ROI) 1-800 928 308

Monday-Friday 8.30am to 6.30pm

Saturday-Sunday 9.00am to 5.00pm

## Consumables

To purchase spares and accessories, please visit [vax.co.uk](http://vax.co.uk)

The use of genuine vax spare parts helps to maintain optimised performance and validates your guarantee

Filter Kit (Type 65): 1-1-132164-00

Upholstery tool (Type 3): 1-1-132116-00

Turbo Tool (Type 3): 1-1-132430-00

Crevice tool (Type 9): 1-3-128633-00

Dusting Brush (Type 5): 1-9-127512-00

## Technical Specification

Voltage: 220-240V -50Hz

Filters: Pre-motor filter (washable)

H12 HEPA (anti-bacterial) Post-motor filter (dependant on model)

Subject to technical change without notice.



## EEC Statement of Compliance

Manufacturer/EEC importer: Vax Limited, hereby on our own responsibility, declare that the **C88-W2** series is manufactured in compliance with the following Directives:

**Safety:** 2006/95/EC Low Voltage Directive

**EMC:** 2004/108/EC Electromagnetic Compatibility Directive



Waste electrical products should not be disposed of with household waste. Please recycle where facilities exist. Check with your Local Authority or retailer for recycling advice.



# Guarantee

It's quick and easy to register for your  
**FREE 2 year guarantee**  
online at: [vax.co.uk/guarantees](http://vax.co.uk/guarantees)

Please retain your original receipt for proof of purchase.

UK based customer care centre — Open 7 days a week

Monday-Friday 8:30am-18:30pm  
Saturday and Sunday 9:00am-17:00pm

## we're here if you need us

Instead of taking me back to the shop, simply visit:  
[vax.co.uk/support](http://vax.co.uk/support) or call (UK) 0844 412 8455 (ROI) 1-800 928 308

Let us know what you think @VaxUK 



**2 year  
guarantee**



Vax Ltd., Kingswood Road, Hampton Lovett, Droitwich, Worcestershire, WR9 0QH, UK  
email: [info@vax.co.uk](mailto:info@vax.co.uk) website: [vax.co.uk](http://vax.co.uk)